

PRODUCT NO. 70007

ASAHI PENTAX BATTERY GRIP

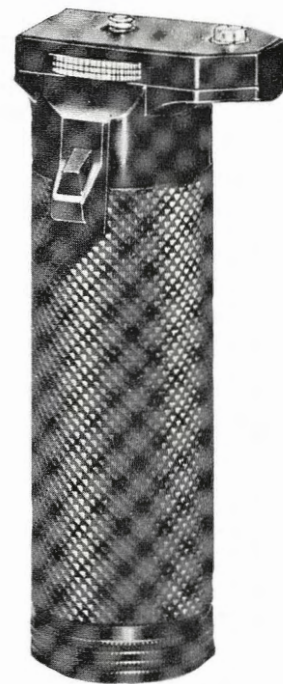

EXPLODED ILLUSTRATION

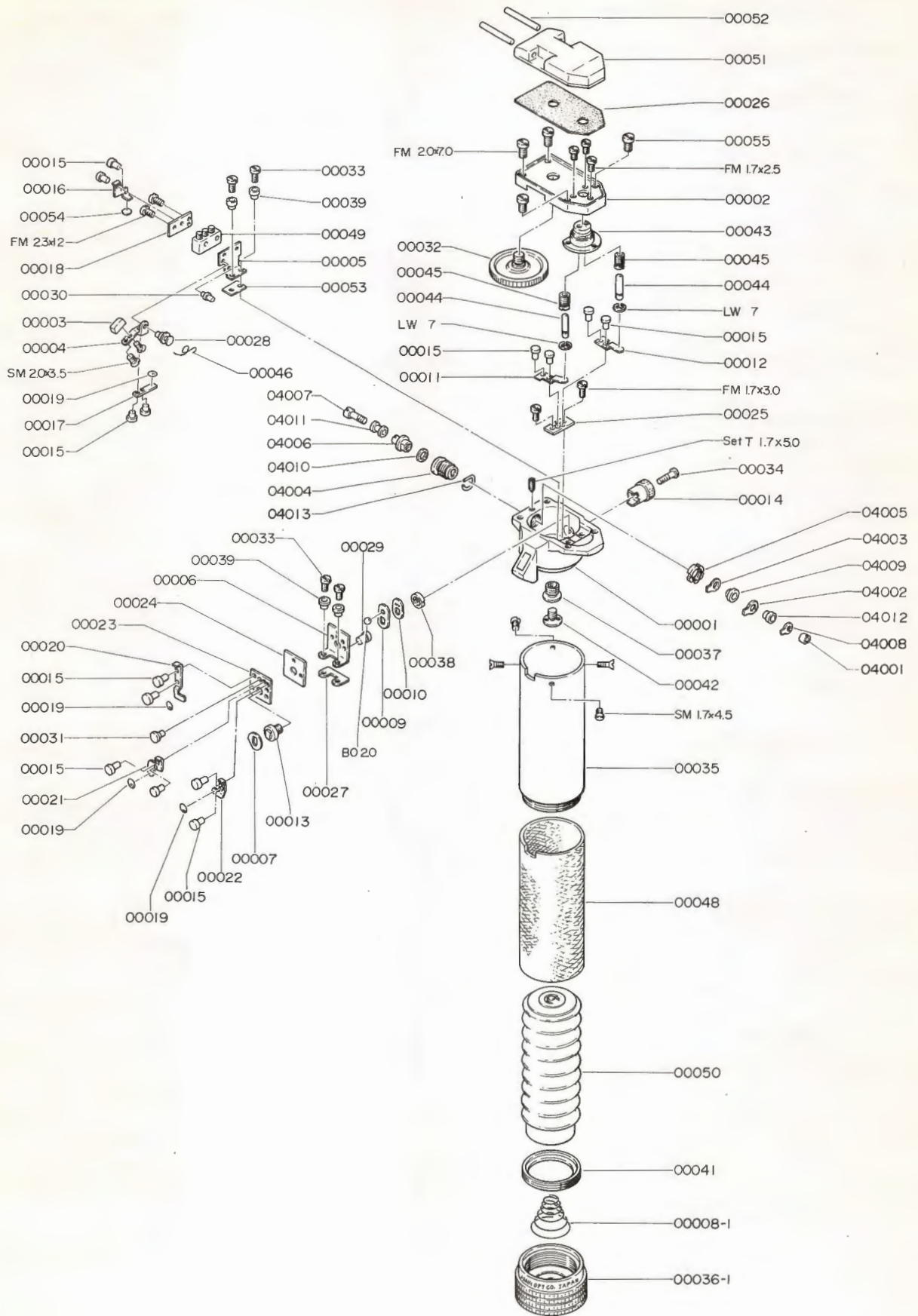

Product No. 70007
ASAHI PENTAX BATTERY GRIP

ILLUSTRATION OF DISTRIBUTING WIRES

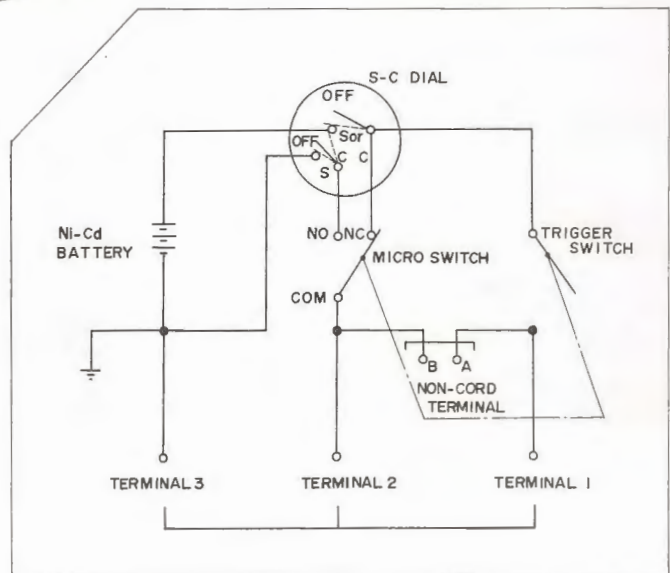
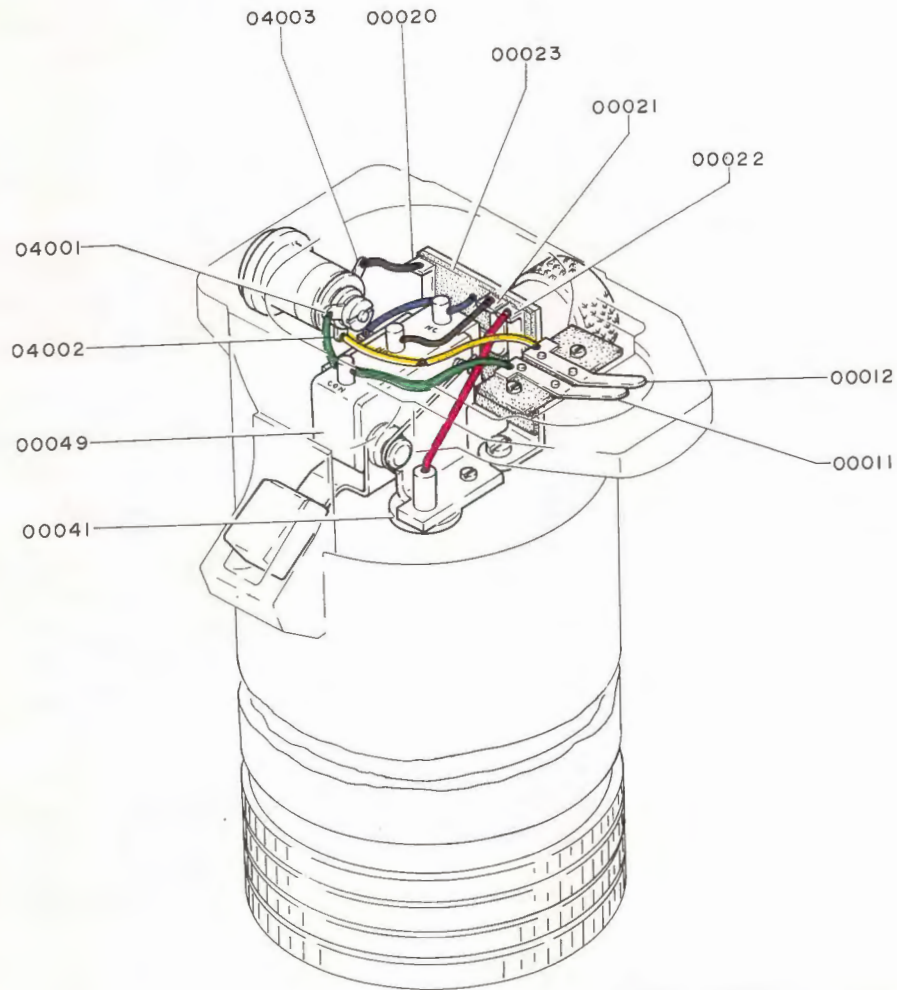

Product No.70007
ASAHI PENTAX BATTERY GRIP

LIST OF SERVICE PARTS

Product No. 70007

ASAHI PENTAX BATTERY GRIP

Note: The parts with numbers starting with '-0' assembled parts.

Part No.	Description	Quantity
00001	Body	1
00002	Top cover	1
00003	Trigger button	1
0-00005	Microswitch seat plate assembly (00005, 00004, 00015×2, 00017, 00019, 00028, 00030, 00054)	1
00008-1	Contact spring	1
00009	Click plate	1
00010	Click spring	1
0-00013	Print plate shaft assembly (00013, 00007)	1
00014	S-C transfer knob	1
0-00018	Switch insulator plate assembly (00018, 00015×2, 00016, 00019)	1
0-00023	Transfer contact piece seat assembly (00023, 00006, 00015×6, 00019×3, 00020, 00021, 00022, 00024, 00027, 00029, 00031)	1
0-00025	Connector insulator plate assembly (00025, 00011, 00012, 00015×4)	1
00026	Rubber	1
00032	Installing screw	1
00033	Switch plate retainer screw	4
00034	Transfer switch knob retainer screw	1
00035	Battery case	1
00036-1	Case cover	1
00037	Anode insulator collar	1
00038	Nut	1

Parts No.	Description	Quantity
00039	Insulator collar	4
00041	Cathode plate retainer nut	1
00042	Anode	1
00043	Connector exterior tube	1
00044	Connector pin	2
00045	Connector interior tube	2
00046	Switch spring	1
00047	DC 12 volt power socket unit	1
00048	Grip rubber	1
00049	Microswitch	1
0-00051	Cover assembly (00051, 00052 × 2)	1
00053	Switch insulator plate	1
00055	Top cover retainer screw	2

LIST OF STANDARD PARTS

Product No. 70007

ASAHI PENTAX BATTERY GRIP

Small Screws

Description	Surface Treatment	Position of Use	Quantity
FM 1.7× 2.5	Black nickel	00043+ 00002	3
FM 1.7× 3	//	00025+ 00001	2
FM 2× 7	//	00002+ 00001	2
FM 2.3× 9	//	00018 00049+ 00005	1
FM 2.3× 12	//	00018+ 00049+ 00005	1
SM 1.7× 4.5	//	00035+ 00001	4
SM 2× 3.5	//	00004+ 00003	2
Set T 1.7× 5	//	00001+ 00047	1

Lock Washer

Description	Material	Position of Use	Quantity
LW 7	Steel	00044	2

Ball

Description	Material	Diameter	Position of Use	Quantity
BO 2	Steel	2.0	00006+ 00009+ 00010	1