

Parts Catalog

適応

本サービスマニュアルのデータは、該当製品のサービスを行う技術者が修理を行うためのツールとして、キヤノン株式会社が発行しています。本サービスマニュアルのデータは、該当製品が販売される地域に対応する内容で作成されているため、貴地域に非該当の製品の情報が記載されている場合があります。下記の内容は本サービスマニュアルおよび製品が使用される国の法律及び各例に合致しない場合には、適用されません。

情報改訂

本サービスマニュアルには、該当製品の改良変更のため、技術的に不正確な記述、あるいはミスプリントが含まれることがあります。これらの理由により、本サービスマニュアルの内容に変更が発生した場合には、発行元の判断によりサービスインフォメーションを発行します。また、本サービスマニュアルの内容に大幅な変更が生じた場合には、発行元の判断により改訂版を発行します。

商標

本サービスマニュアルに記載されている各製品名、各会社名は各社の登録商標です。

著作権

本サービスマニュアルの著作権は、キヤノン株式会社に帰属しています。キヤノン株式会社の書面による同意の無い場合には本サービスマニュアルの一部あるいは、全体を複製・閲覧（web等を含む）・転載・加工（変更）・他の言語への翻訳等が禁止されています。

Copyright © 2016 Canon Inc.

キヤノン株式会社

カメラレンズサービス・品質保証課

〒146-8501 東京都大田区下丸子 3-30-2

2016年9月発行

Application

This Service Manual is issued by Canon Inc. for qualified persons to learn technical theory and product repair. This Service Manual covers all localities where the products are sold. For this reason, there may be information in this Service Manual that does not apply to the product sold in your locality. The following paragraph does not apply to any countries where such provisions are inconsistent with local law.

Information revision

This Service Manual could include typographical errors or technical inaccuracies due to improvements or changes in the products. For this reason, when changes occur in the content of this Service Manual, Canon will release service information as the need arises. In the event of major changes in the content of this Service Manual, Canon may issue new editions of this Service Manual at its discretion.

Trademarks

The product names and company names described in this Service Manual are the registered trademarks of the individual companies.

Copyright

Canon Inc. retains the copyright to this Service Manual. Reproduction, publication (including on the World Wide Web), alteration, translation into another language, or other use of the data in whole or part, contained on this Service Manual without the written consent of Canon Inc. is prohibited.

Copyright © 2016 Canon Inc.

Canon Inc.

Camera-Lens Products Service & Quality Assurance Dept.
30-2, Shimomaruko 3-Chome, Ohta-ku, Tokyo 146-8501, Japan

First published September, 2016

Canon

EF24-105mm F4L IS II USM

REF. NO. C21-0262

PARTS CATALOG

AL-2403 **E** **J**

Repair Work Added

修理作業の追加

AL-2365 **E** **J**

Streamlining of TELE Infinity Focus Adjustment

TELEの無限ピント調整の効率化

AL-2358 **E** **J**

Revision of Service Manual

サービスマニュアルの改訂

AL-2342 **E** **J**

Operation Necessary When Replacing SLEEVE ASS'Y, GUIDE

SLEEVE ASS'Y, GUIDEの交換時について

AL-2434 **E** **J**

Error Correction in Expendable Used

使用補材の誤記訂正

Copyright © 2016 Canon Inc.

CANON LENS EF24-105mm F4L IS II USM

PARTS LIST

REF. NO. C21-0262

CY1-2178-000(XXX) detail

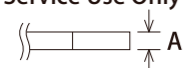
Service Use Only	A	SIZE
	0.02 mm	(002)
	0.05 mm	(005)

CY3-2395-000(XXX) detail

A	SIZE
2.3 mm	(230)
2.4 mm	(240)
2.5 mm	(250)
2.6 mm	(260)
2.7 mm	(270)
2.8 mm	(280)
2.9 mm	(290)

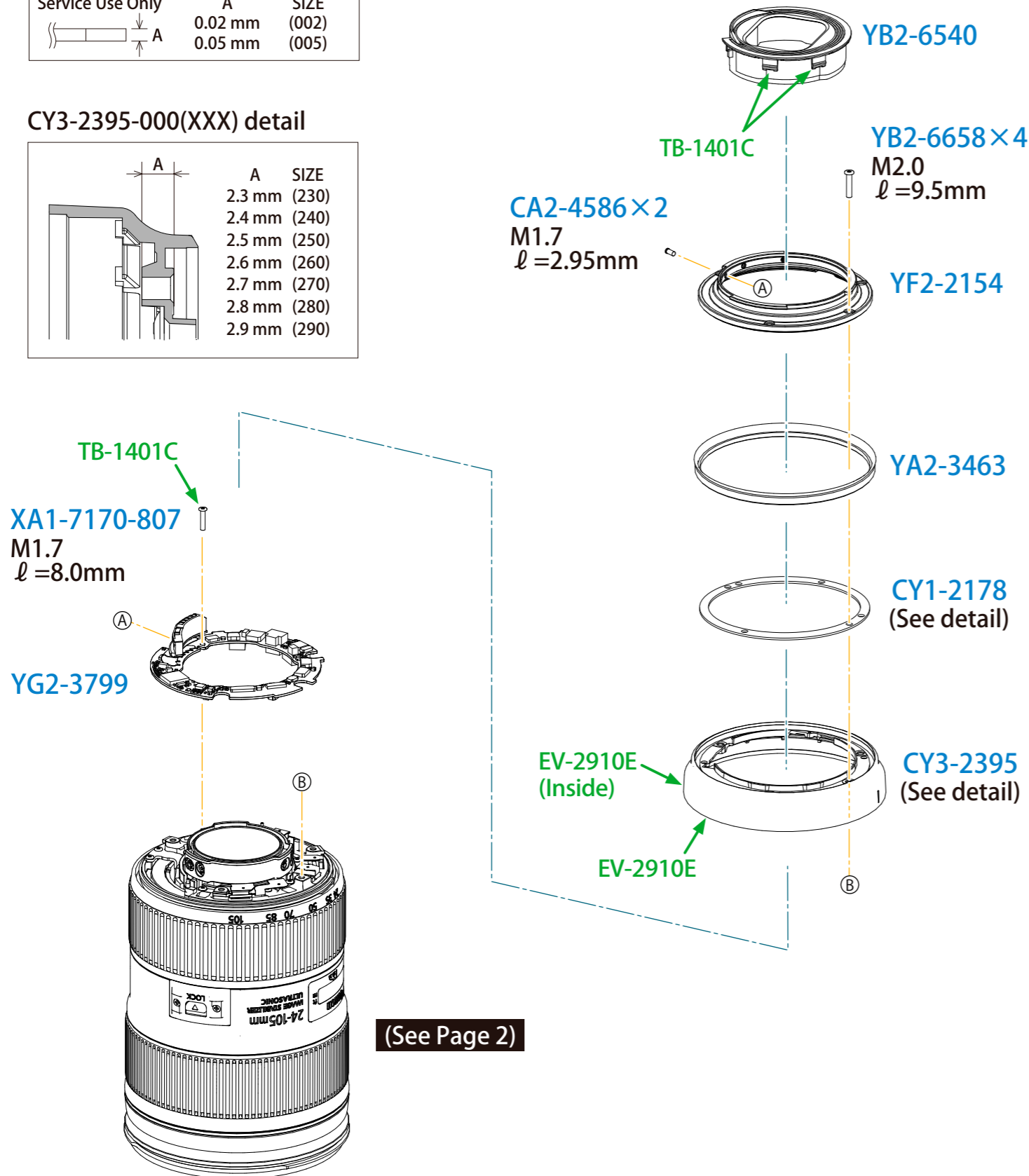

NEW	PARTS NO.	CLASS	QTY	DESCRIPTION
	CA2-4586-000	E	2	SCREW
	CY1-2178-000(XXX)	E	1	WASHER, MOUNT
*	CY3-2395-000(XXX)	B	1	SLEEVE ASS'Y, REAR
*	XA1-7170-807	F	1	SCREW
	YA2-3463-000	C	1	RING, MOUNT (RUBBER)
*	YB2-6540-000	C	1	COVER, BACK
*	YB2-6658-000	C	4	SCREW, M2.0X.9.5
	YF2-2154-000	C	1	MOUNT ASS'Y
*	YG2-3799-000	B	1	PCB ASS'Y, MAIN

EV-2910E	LUBE, DRYSURF EV-2910E	CY9-8186-000
TB-1401C	BOND, THREE BOND 1401C	CY9-8011-000

CANON LENS EF24-105mm F4L IS II USM

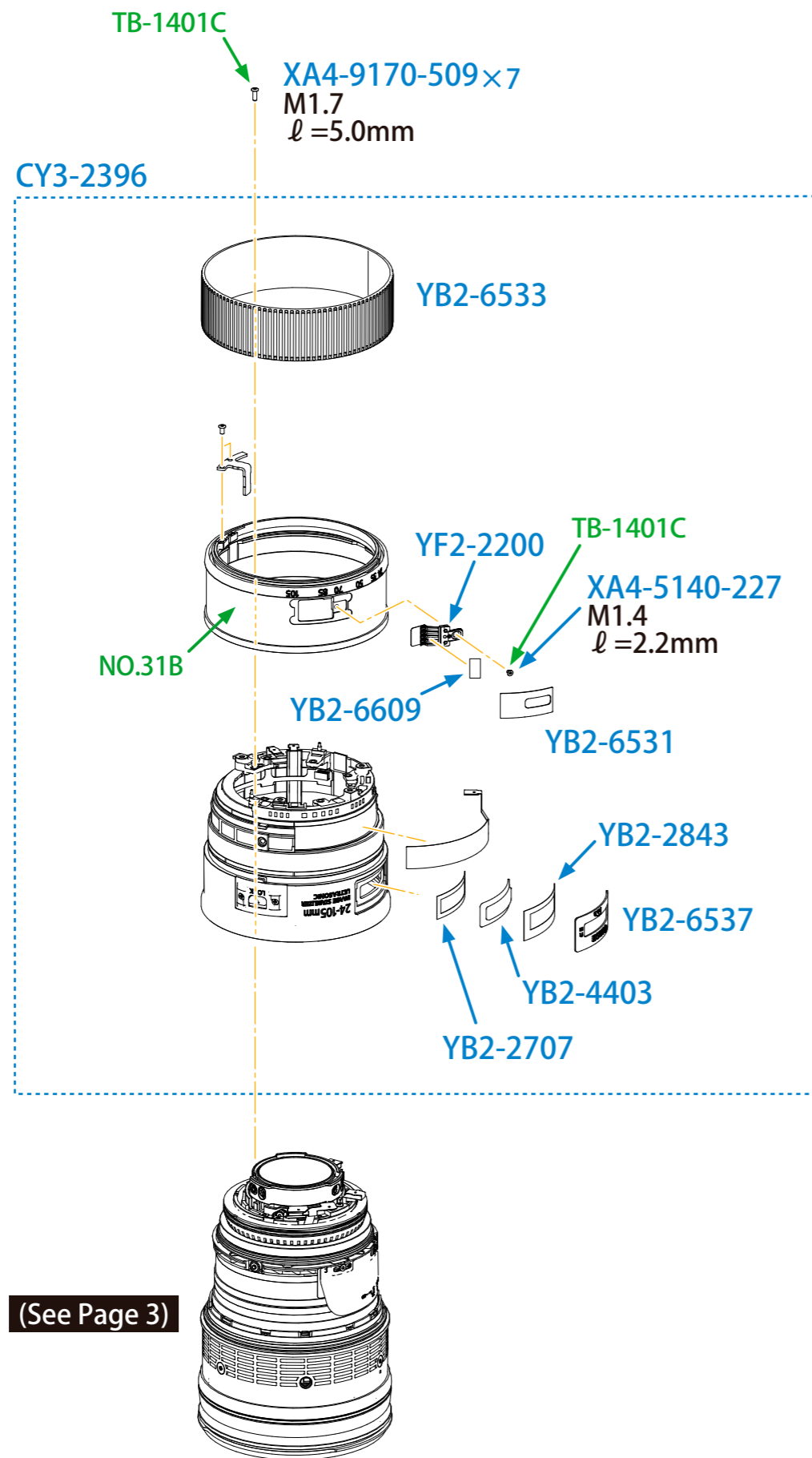

PARTS LIST

REF. NO. C21-0262

NEW	PARTS NO.	CLASS	QTY	DESCRIPTION
*	CY3-2396-000	C	1	BARREL ASS'Y, FIXED
	XA4-5140-227	F	1	SCREW, SELF-TAPING, M1.4X2.2
	XA4-9170-509	F	7	SCREW, CROSS-RECESS, PH
	YB2-2707-000	C	1	TAPE, DOUBLE SIDED
	YB2-2843-000	C	1	TAPE, DOUBLE SIDED
	YB2-4403-000	C	1	WINDOW, SCALE
*	YB2-6531-000	C	1	COVER, ZOOM BRUSH
*	YB2-6533-000	D	1	RING, ZOOM RUBBER
*	YB2-6537-000	C	1	PLATE, NAME
*	YB2-6609-000	C	1	RUBBER, VIBRATION
	YF2-2200-000	C	1	BRUSH, ZOOM

NO.31B	TAPE, (NO.31B)	CY9-4044-000
TB-1401C	BOND, THREE BOND 1401C	CY9-8011-000

CANON LENS EF24-105mm F4L IS II USM

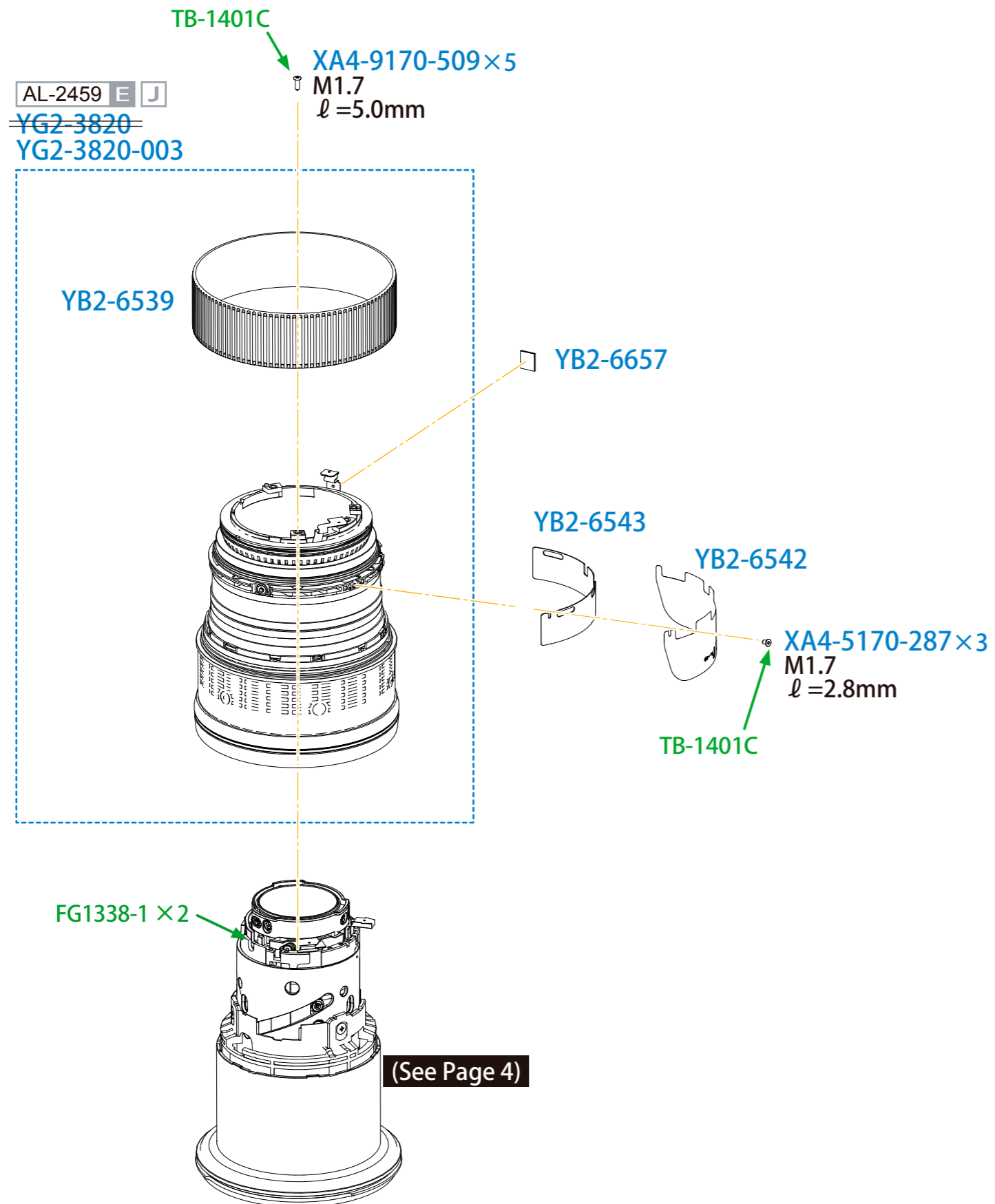

PARTS LIST

REF. NO. C21-0262

NEW	PARTS NO.	CLASS	QTY	DESCRIPTION
*	XA4-5170-287	C	3	SCREW, M1.7X2.8
	XA4-9170-509	F	5	SCREW, CROSS-RECESS, PH
*	YB2-6539-000	D	1	RING, FOCUS RUBBER
*	YB2-6542-000	C	1	SHEET, FOCUS SCALE
*	YB2-6543-000	B	1	PLATE, FOCUS SCALE
*	YB2-6657-000	C	1	CUSHION, GYRO HOLD
*	YG2-3820-003	C	1	FOCUSING ASS'Y, USM (RUBBER)

~~* YG2-3820-000 C 1 FOCUSING ASS'Y, USM~~

FG1338-1	LUBE, FG1338-1	CY9-8187-000
TB-1401C	BOND, THREE BOND 1401C	CY9-8011-000

CANON LENS EF24-105mm F4L IS II USM

PARTS LIST

REF. NO. C21-0262

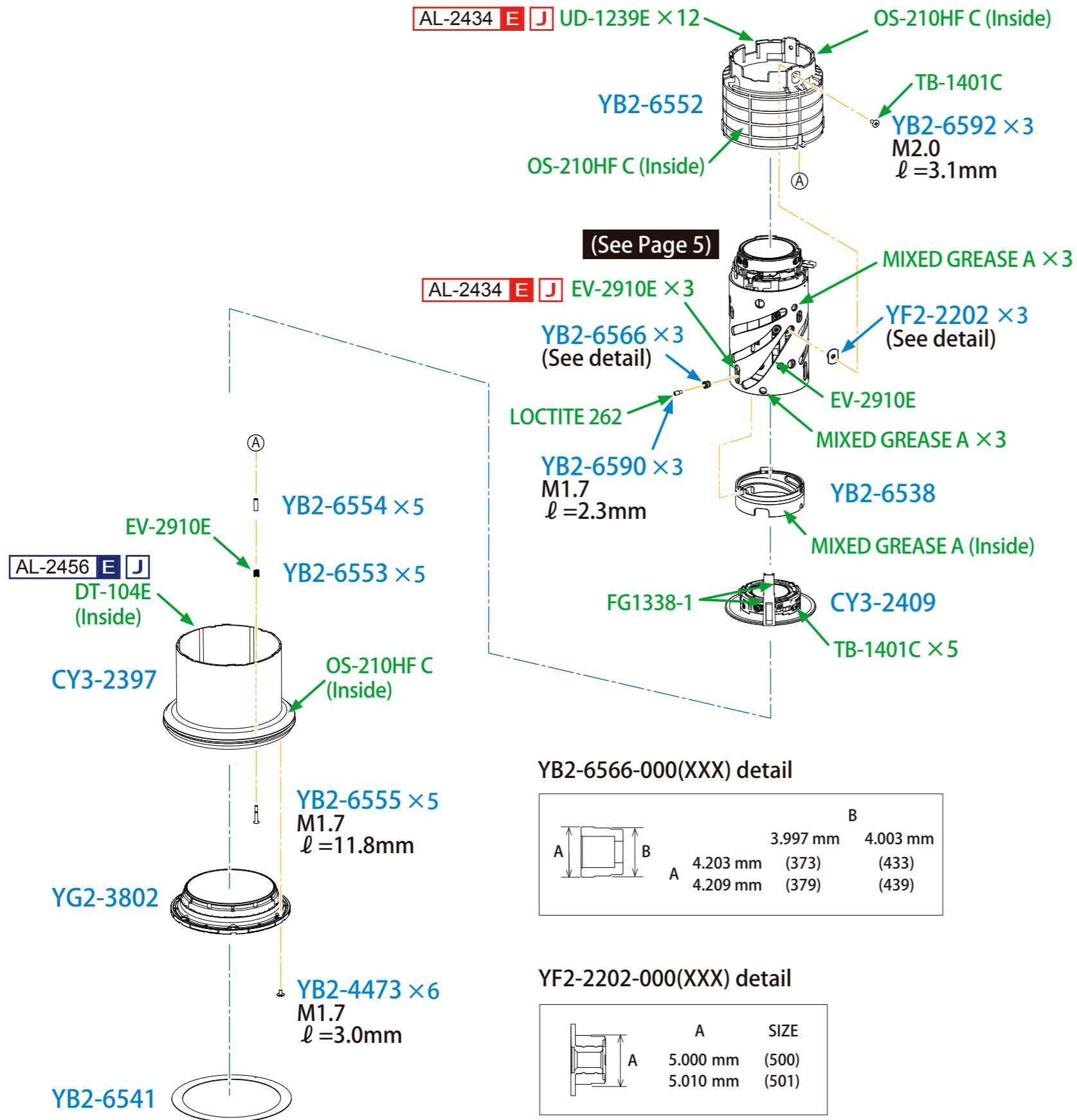

NEW	PARTS NO.	CLASS	QTY	DESCRIPTION
*	CY3-2397-000	C	1	SLEEVE, FILTER
*	CY3-2409-000	C	1	LENS ASS'Y, 2ND GROUP
	YB2-4473-000	C	6	SCREW, M1.7X3.0
*	YB2-6538-000	C	1	SLEEVE, FOCUS CAM
*	YB2-6541-000	C	1	RING, NAME
*	YB2-6552-000	C	1	SLEEVE, STRAIGHT MOVE
*	YB2-6553-000	C	5	SPRING, FILTER SLEEVE
*	YB2-6554-000	C	5	WASHER, FILTER SLEEVE
*	YB2-6555-000	C	5	SCREW, SHAFT M1.7X11.8
*	YB2-6566-000(XXX)	C	3	COLLAR
*	YB2-6590-000	C	3	SCREW, SHAFT M1.7X2.3
*	YB2-6592-000	C	3	SCREW, SHAFT M2.0X3.1
*	YF2-2202-000(XXX)	C	3	COLLAR
*	YG2-3802-000	C	1	LENS ASS'Y, 1ST GROUP

MIXED GREASE A			
LUBE, FG1338-1	80%	CY9-8187-000	
LUBE, TEFLON PFA MJ-102	20%	CY9-8166-000	
DT-104E	LUBE, DRYSURF DT-104E	CY9-8195-000	
EV-2910E	LUBE, DRYSURF EV-2910E	CY9-8186-000	
FG1338-1	LUBE, FG1338-1	CY9-8187-000	
LOCTITE 262	LOCAL PROCUREMENT		
OS-210HF C	LUBE, DRYSURF OS-210HF C	CY9-8174-000	
TB-1401C	BOND, THREE BOND 1401C	CY9-8011-000	
UD-1239E	LUBE, HANARL UD-1239E GREASE	CY9-8172-000	

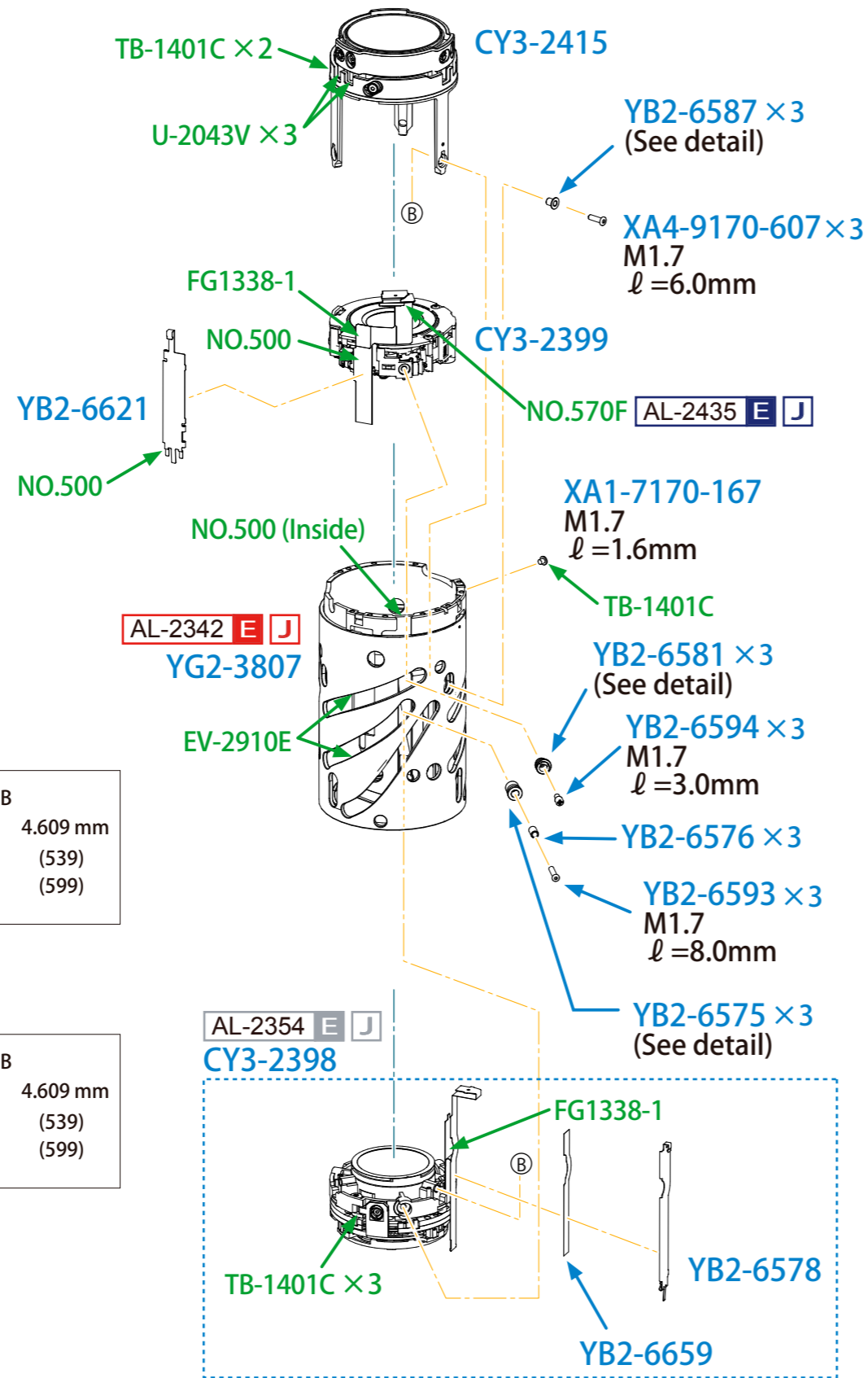

YB2-6575-000(XXX) detail

		B	
A		4.603 mm	4.609 mm
	5.003 mm (533)	(539)	(539)
	5.009 mm (593)	(599)	(599)

YB2-6581-000(XXX) detail

		B	
A		4.603 mm	4.609 mm
	5.203 mm (533)	(539)	(539)
	5.209 mm (593)	(599)	(599)

YB2-6587-000(XXX) detail

A	SIZE
2.400 mm	(400)

NEW	PARTS NO.	CLASS	QTY	DESCRIPTION
*	CY3-2398-000	C	1	LENS ASS'Y, EMD, 3RD GROUP
*	CY3-2399-000	C	1	LENS ASS'Y, IS, 4TH GROUP
*	CY3-2415-000	C	1	LENS ASS'Y, 5TH GROUP
*	XA1-7170-167	F	1	SCREW, CROSS-RECESS, PH
	XA4-9170-607	F	3	SCREW, CROSS-RECESS, PH
*	YB2-6575-000(XXX)	C	3	COLLAR
*	YB2-6576-000	C	3	COLLAR
*	YB2-6578-000	C	1	HOLDER, E-FPC
*	YB2-6581-000(XXX)	C	3	COLLAR, DECENTERING
*	YB2-6587-000(XXX)	C	3	COLLAR
*	YB2-6593-000	C	3	SCREW, M1.7X8.0
*	YB2-6594-000	C	3	SCREW, SHAFT M1.7X3.0
*	YB2-6621-000	C	1	HOLDER, IS-FPC
*	YB2-6659-000	C	1	TAPE, DOUBLE-SIDED
*	YG2-3807-000	C	1	SLEEVE ASS'Y, GUIDE

EV-2910E	LUBE, DRYSURF EV-2910E	CY9-8186-000
FG1338-1	LUBE, FG1338-1	CY9-8187-000
NO.500	TAPE, DOUBLE SIDED (NO.500)	CY9-4034-000
NO.570F	TAPE (NO.570F) ACETATE(R)	CY9-4026-000
TB-1401C	BOND, THREE BOND 1401C	CY9-8011-000
U-2043V	BOND, U-2043V	CY9-8185-000

CANON LENS EF24-105mm F4L IS II USM

PARTS LIST

REF. NO. C21-0262

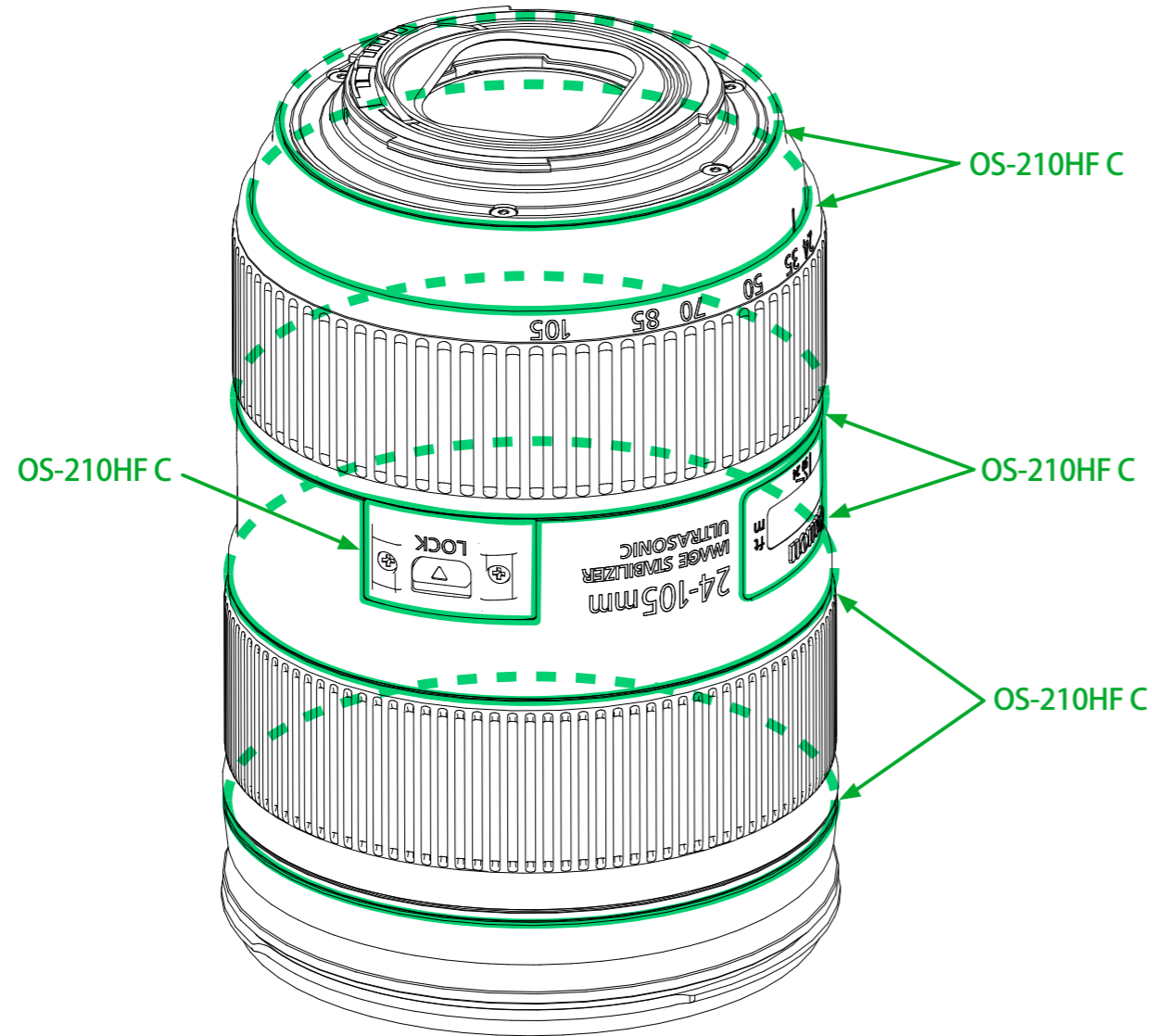

NEW	PARTS NO.	CLASS	QTY	DESCRIPTION
-----	-----------	-------	-----	-------------

OS-210HF C	LUBE, DRYSURF	OS-210HF C		CY9-8174-000
------------	---------------	------------	--	--------------

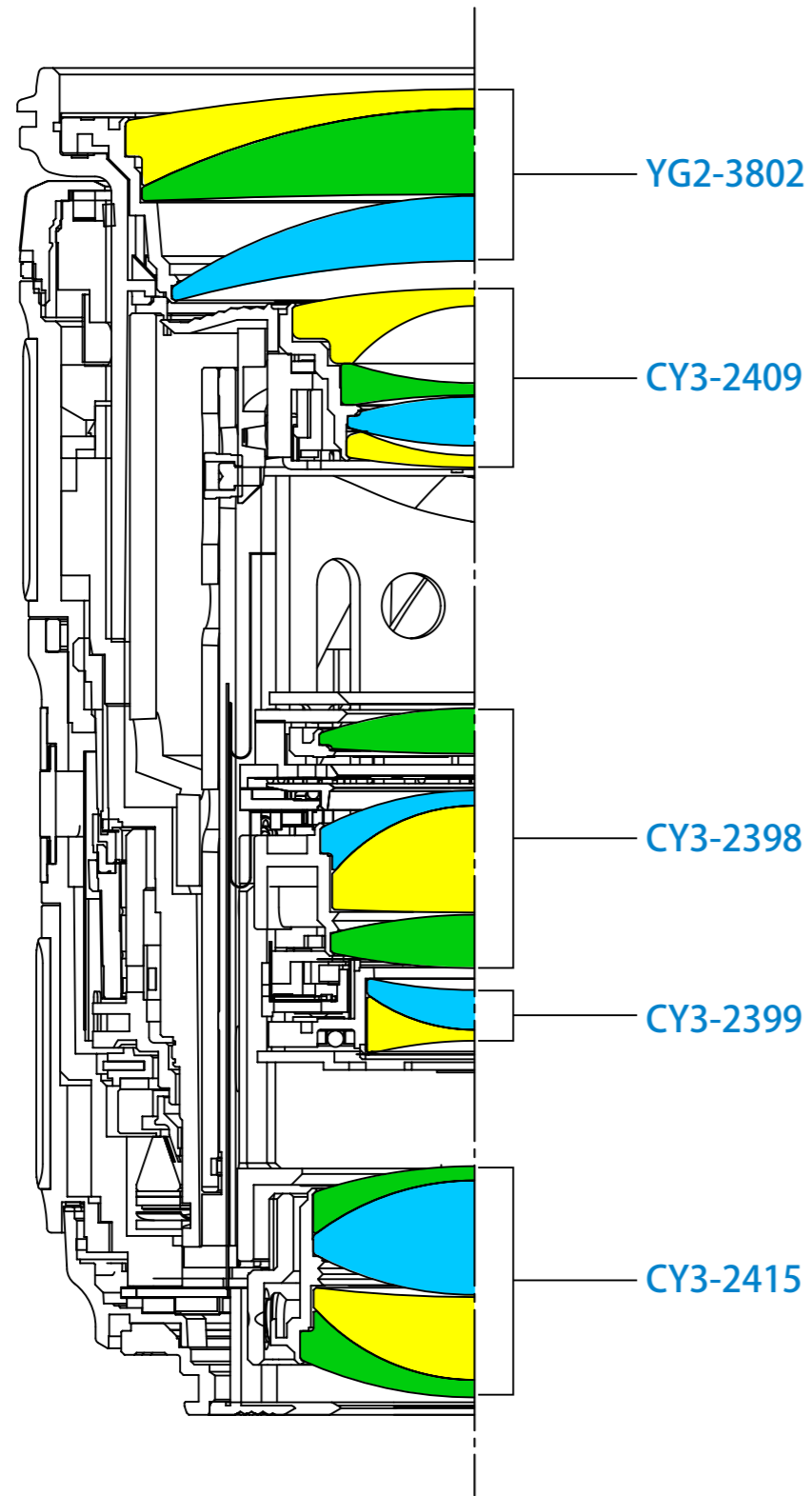

Accessories section

N.S REF.No.C45-7701
LENS CAP E-77II

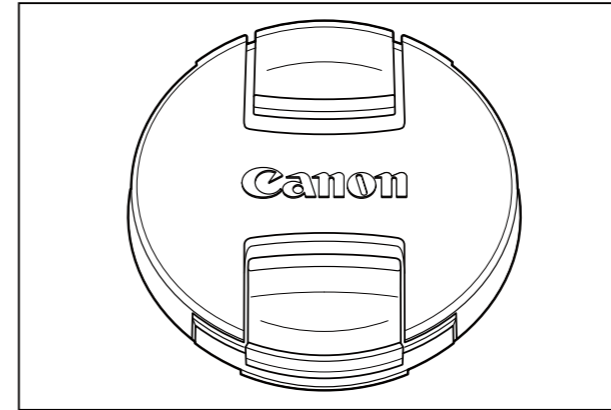

N.S REF.No.C45-5402
LENS DUST CAP E



N.S REF.No.C47-1471/1472
LENS CASE LP1219



N.S REF.No.C44-8501
LENS HOOD EW-83M

